

**MHTN**  
ARCHITECTS  
MHTN Architects, Inc.  
420 East South Temple  
Suite 100  
Salt Lake City, Utah 84111  
Telephone (801) 595-6700  
Telexfax (801) 595-6717  
www.mhtn.com



**NEBO SCHOOL DISTRICT**  
**NSD MAPLE GROVE MIDDLE SCHOOL**  
400 S 1600 W  
MAPLETON, UT 84664

©2018 MHTN ARCHITECTS, INC.  
Confidentiality Notice:  
This document is intended for use on the Project identified herein by individuals and/or companies associated with the design, construction, bidding and construction of the Project. MHTN Architects, Inc. grants limited rights to distribute and otherwise use this document for the address specified only. Distribution, printing or copying this document for purposes other than those indicated is strictly prohibited. If a digital copy of this document is received in error, please contact us.

MHTN PROJECT NO. 2018561.00

Original drawing is 30" x 42". Do not scale contents of the drawing.

REVISIONS:  
CONTRACTOR TO VERIFY DRAWINGS IN FIELD. USE REFLECT  
LAST REVISION DATE.

| NO. | DATE | DESCRIPTION |
|-----|------|-------------|
|     |      |             |
|     |      |             |
|     |      |             |
|     |      |             |
|     |      |             |
|     |      |             |
|     |      |             |
|     |      |             |
|     |      |             |
|     |      |             |
|     |      |             |
|     |      |             |

ISSUE  
CONSTRUCTION DOCUMENTS  
18 OCTOBER 2019

SHEET NAME

**ROTATED SITE OPTION**

SHEET NUMBER

**AS101**

C:\Users\dakem\Documents\A19-2018562-NSD\_Spring Canyon MS\_Dakem.rvt  
10/19/19 10:19:51 AM

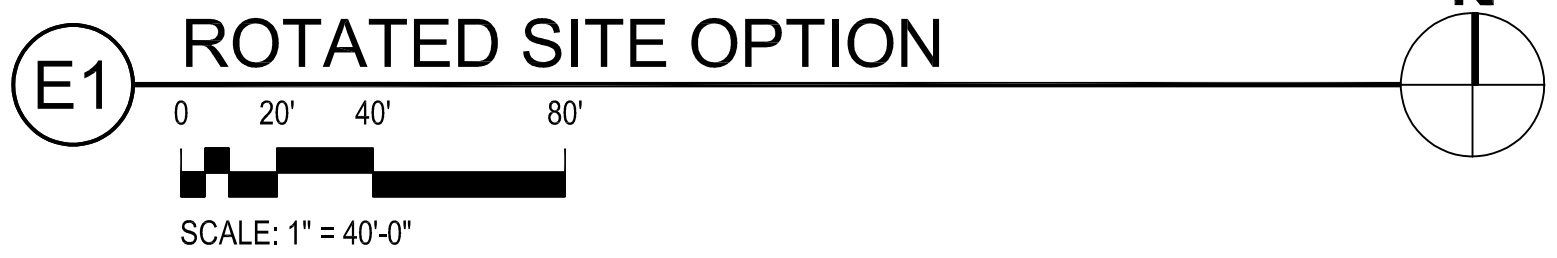

**E1 ROTATED SITE OPTION**

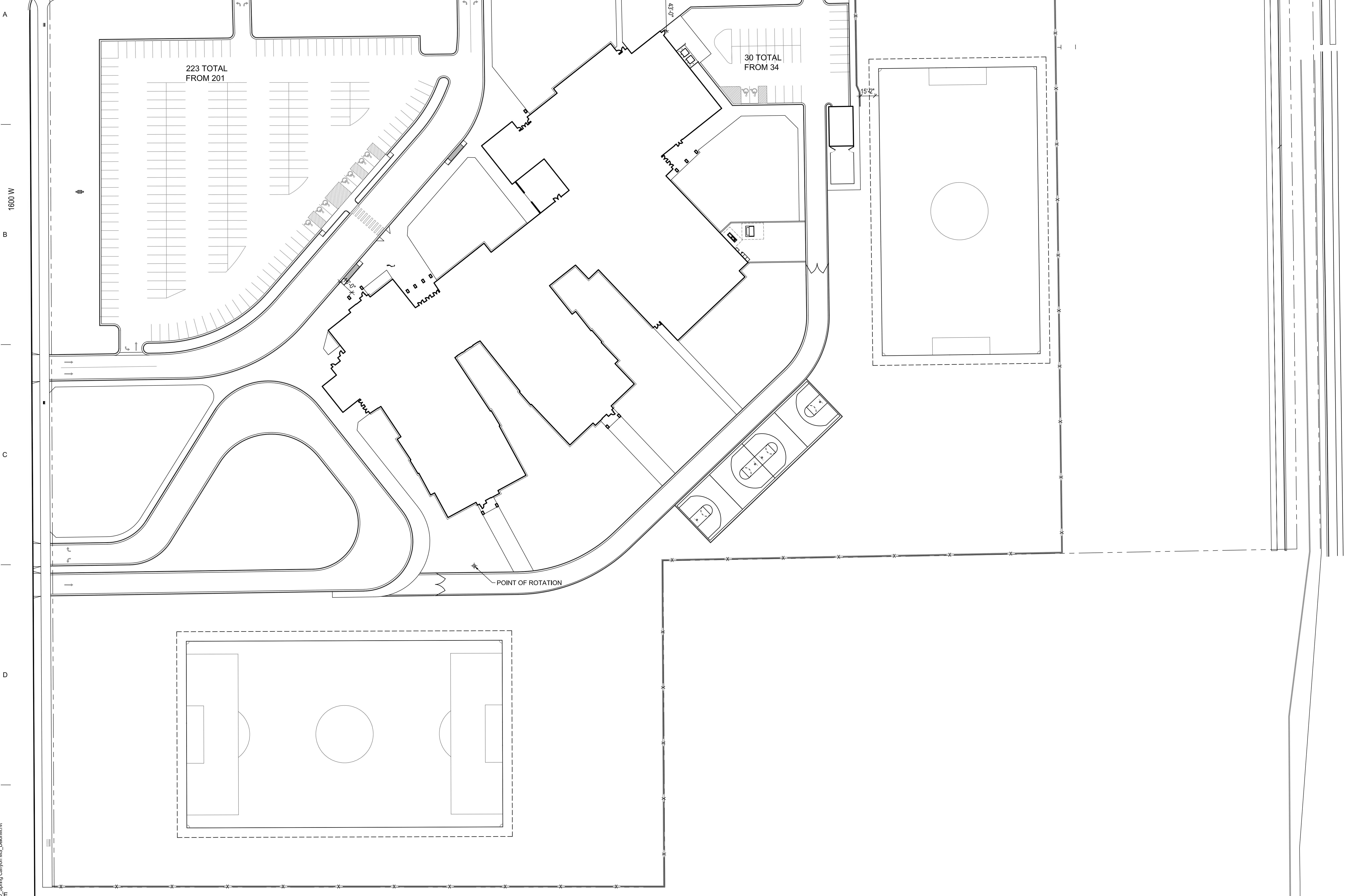

400 S

1600 W

223 TOTAL  
FROM 201

30 TOTAL  
FROM 34

POINT OF ROTATION

A B C D E

1 2 3 4 5